

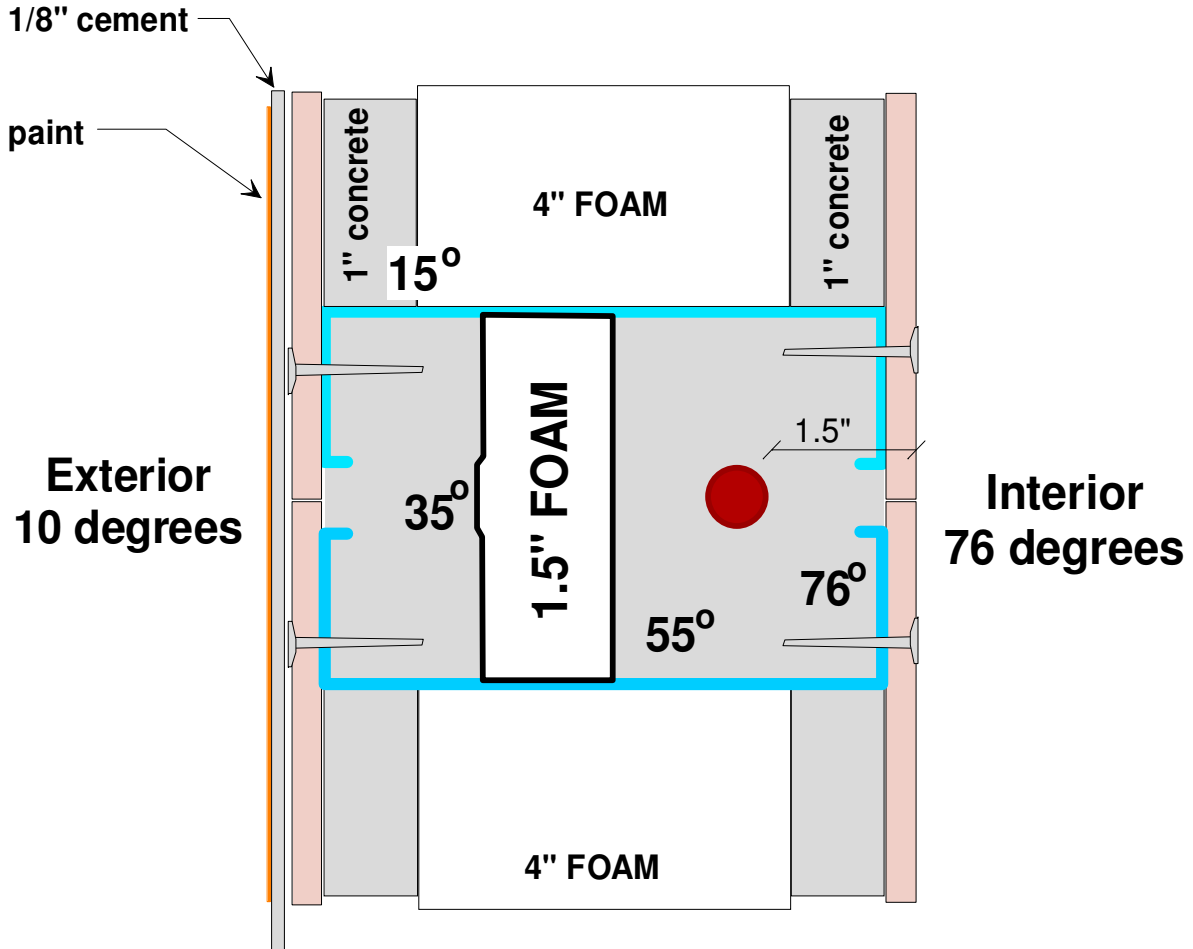

The All Wall System minimizes Thermal Transference at the columns, in home building areas where the homes need to be heated, by installing foam that is 25% of the thickness of the concrete wall.

All other components stay the same.



In conditions where the home needs to be heated. The columns of the All Wall System have 1/2" of foam placed towards the outside of the columns. The exterior cladding and the foam material needs to be 25% of the thickness of the concrete wall in order to minimize the transference of cold into the interior of the home.